

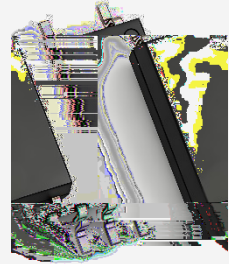

### DESCRIPTION:

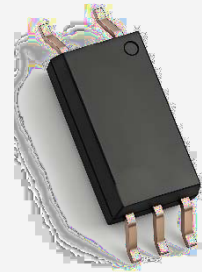

JOCDA1BB L5



JOCDA1BB L5W

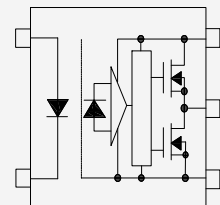

### MAIN FEATURES

### Truth Table





**SWITCHING SPECIFICATION**

Parameter	Symbol	Condition	Min.	Typ.	Max.	Unit

--	--	--	--	--	--	--

All Typical values at  $T_a=25$

**Note1:** Input signal ( $f=25\text{kHz}$ ,  $\text{duty}=50\%$ ,  $t_r=t_f=5\text{ns}$  or less).  $C_L$  is less than 15 pF which includes probe and stray wiring capacitance.

**Note2:**  $CM_H$  is the maximum rate of fall of the common mode voltage that can be sustained with the output voltage in the logic high state ( $V_O = 2.6\text{V}$ ).

**Note3:**  $CM_L$  is the maximum rate of rise of the common mode voltage that can be sustained with the output voltage in the logic low state ( $V_O = 1\text{V}$ ).

**Recommended Operating Conditions**

Characteristics	Symbol	Min.	Typ.	Max.	Unit

**Note1:** The recommended operating conditions are given as a design guide necessary to obtain the intended performance of the device. Each parameter is an independent value. When creating a system design using this device, the electrical characteristics specified in this datasheet should also be considered.

**Note2:** A ceramic capacitor (0.1μF) should be connected between pin 6 ( $V_{CC}$ ) and pin 4 (GND) to stabilize the operation of a high gain linear amplifier. Otherwise, this photocoupler may not switch properly. The bypass capacitor should be placed within 1 cm of each pin.

**Note3:** The rise and fall times of the input on current should be less than 0.5 μs.

**Note4:** If the rising slope of the supply voltage ( $V_{CC}$ ) for the detector is steep, stable operation of the internal circuits cannot be guaranteed. Be sure to set 3 V/μs or less for a rising slope of the  $V_{CC}$ .

**Note5:** Denotes the operating range, not the recommended operating condition.

**ORDERING INFORMATION**

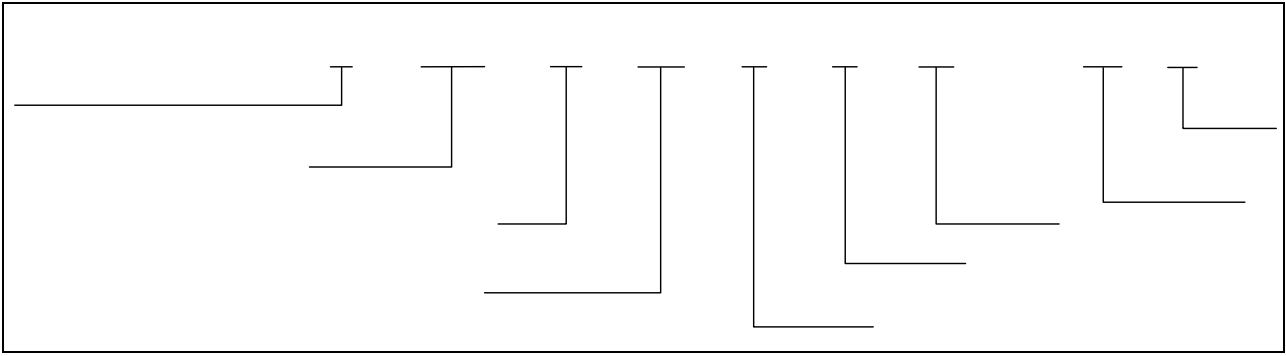

Packing Quantity	
Option	Quantity
None/R	3000 Units/Reel

**MARKING**

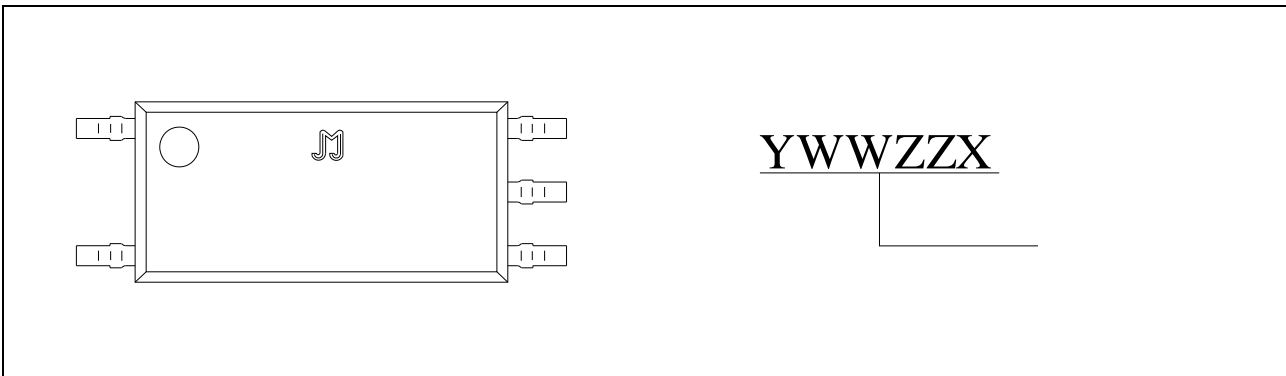

Characteristics Curves

FIG.1:

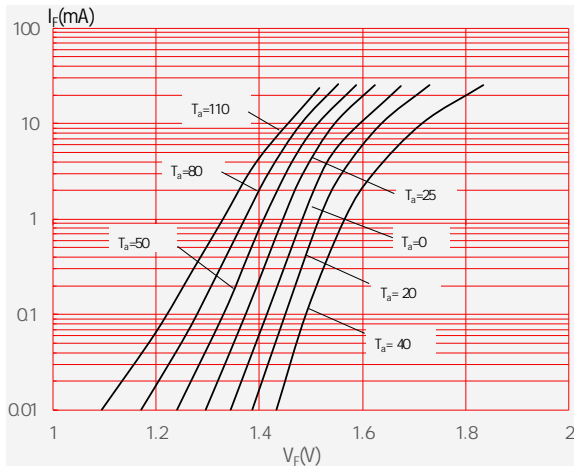

FIG.2:

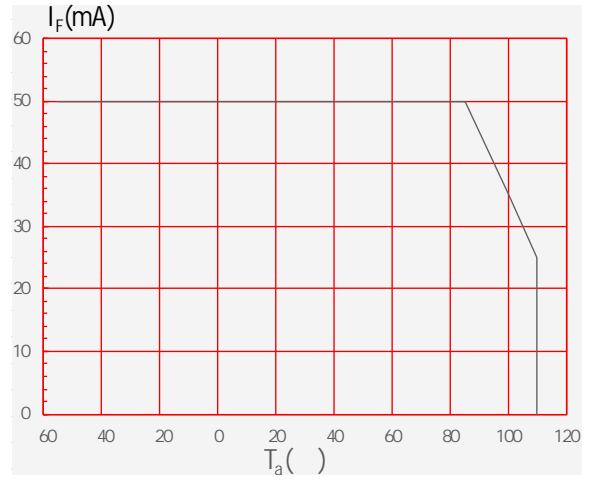

FIG.3:

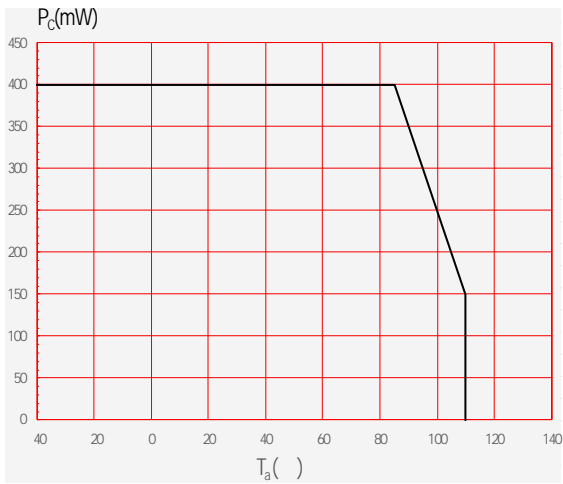

FIG.4:

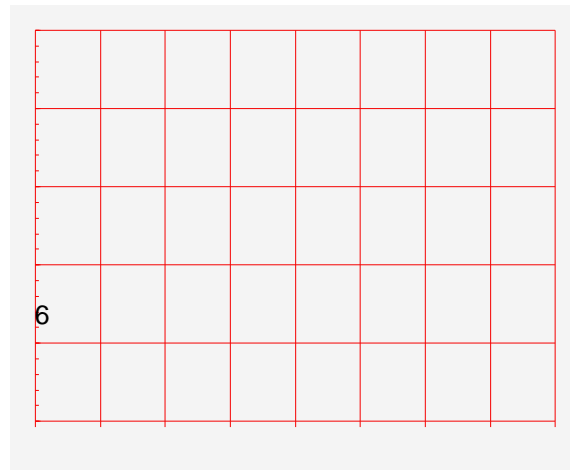

FIG.7:

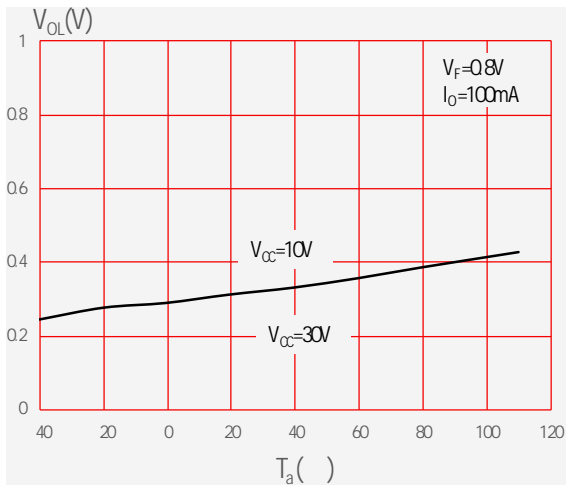

FIG.8:

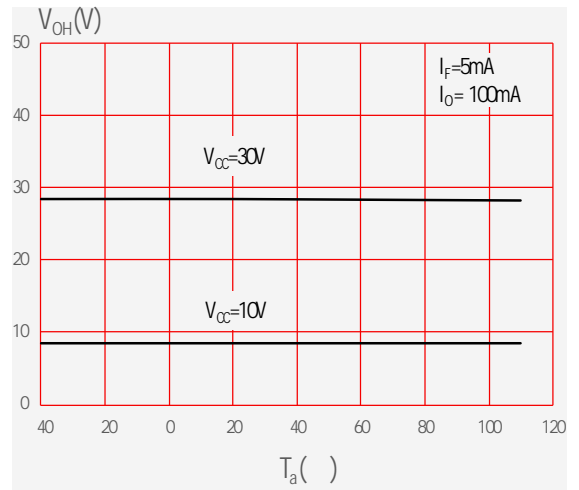

FIG.9:

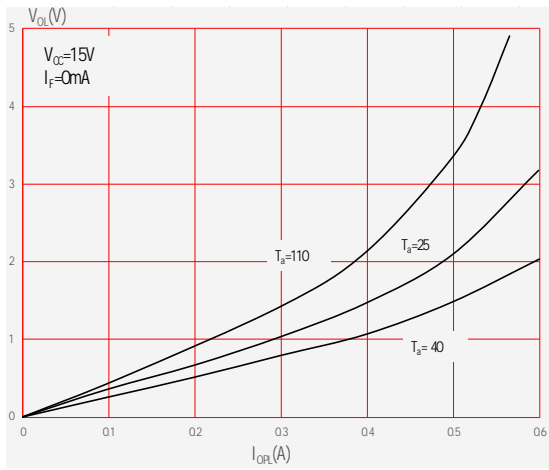

FIG.10:

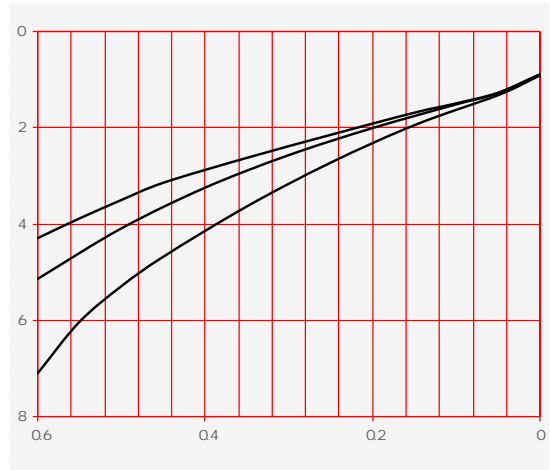
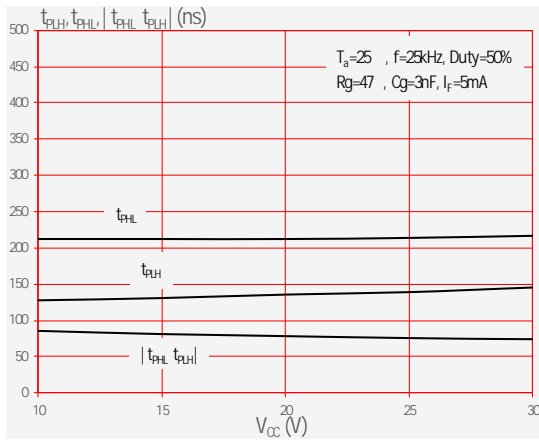

FIG.13:



Test Circuits

FIG.14:

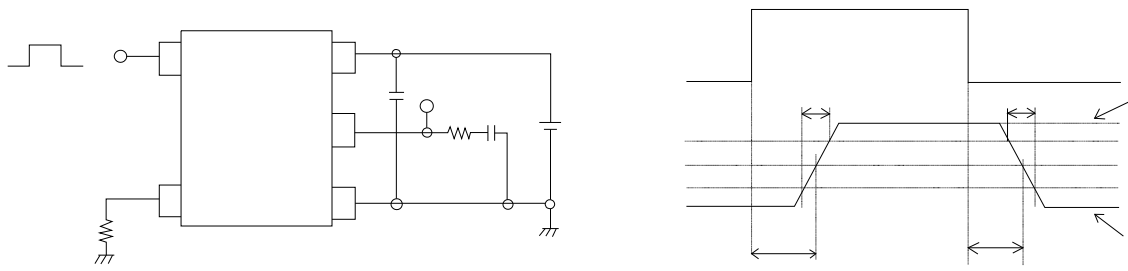
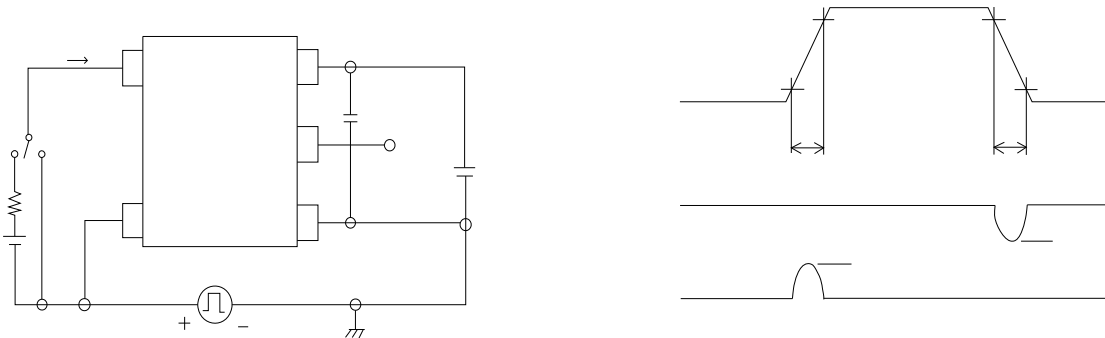
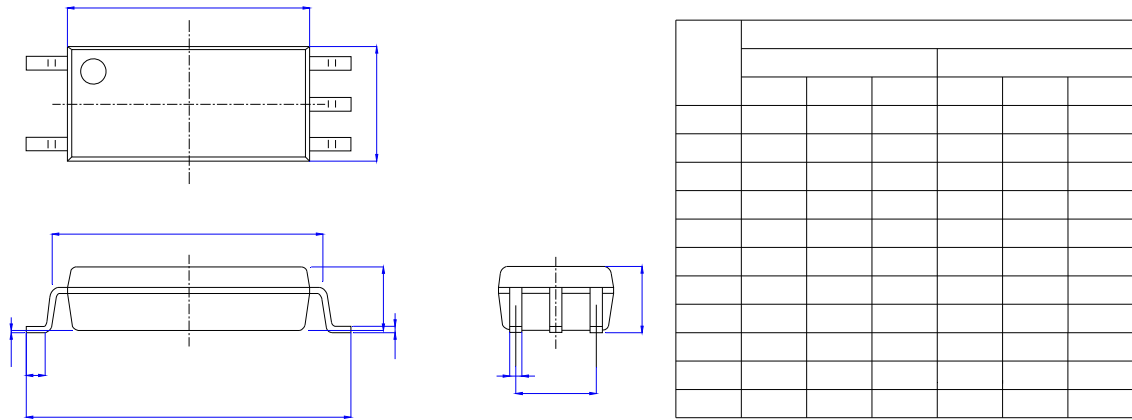

FIG.15:



Package Dimension (Unit: mm)

LSOP5



LSOP5W

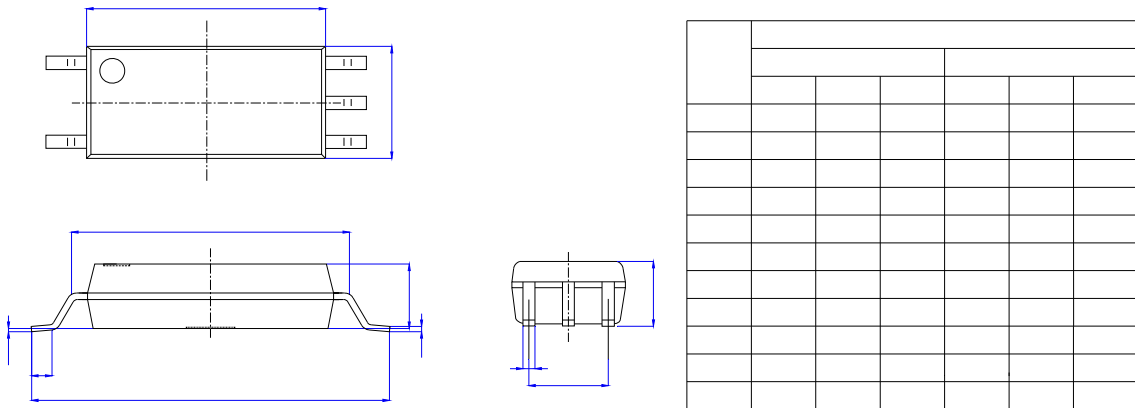

RECOMMENDED SOLDER MASK (Dimensions in mm unless otherwise stated)

LSOP5

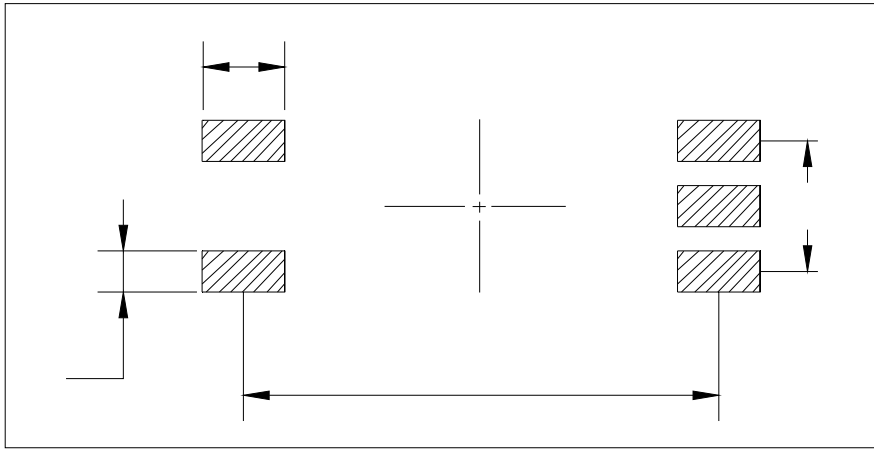

LSOP5W

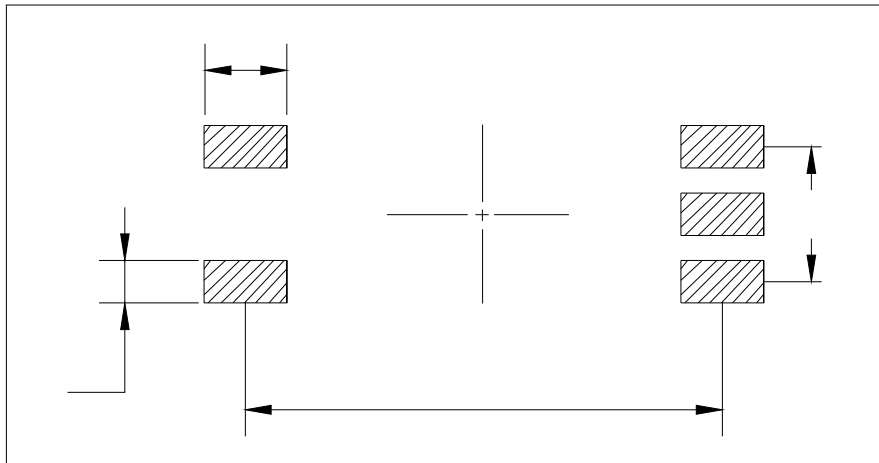

CARRIER TAPE SPECIFICATIONS (Dimensions in mm unless otherwise stated)

Option None/R

